

## ОБЖИМНЫЕ ФИТИНГИ DK-LOK DTBM

Симметричный ввертной тройник

### DTBM-N, -R

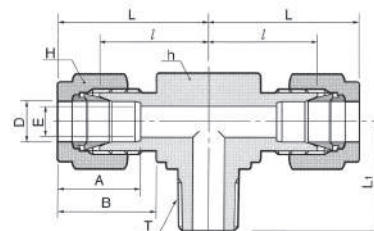

Присоединение трубки дюймовых размеров к внутренней резьбе NPT

| Код         | Наружный диаметр трубки |       |                              |           | Размер гайки под ключ |       |       |       | A     | B     | ℓ     | L      | L1    |
|-------------|-------------------------|-------|------------------------------|-----------|-----------------------|-------|-------|-------|-------|-------|-------|--------|-------|
|             | D                       |       | T<br>Размер<br>резьбы<br>NPT | E<br>Мин. | h                     |       | H     |       |       |       |       |        |       |
|             | дюйм                    | мм    |                              |           | дюйм                  | мм    | дюйм  | мм    |       |       |       |        |       |
| DTBM 1-1N   | 1/16                    | 1.59  | 1/16                         | 1.27      | 7/16                  | 11.11 | 5/16  | 7.93  | 8.63  | 10.92 | 15.24 | 19.05  | 17.78 |
| DTBM 1-2N   | 1/16                    | 1.59  | 1/8                          | 1.27      | 7/16                  | 11.11 | 5/16  | 7.93  | 8.63  | 10.92 | 15.24 | 19.05  | 17.78 |
| DTBM 2-2N   | 1/8                     | 3.17  | 1/8                          | 2.28      | 1/2                   | 12.70 | 7/16  | 11.11 | 12.70 | 15.24 | 18.30 | 24.91  | 18.90 |
| DTBM 2-4N   | 1/8                     | 3.17  | 1/4                          | 2.28      | 1/2                   | 12.70 | 7/16  | 11.11 | 12.70 | 15.24 | 18.30 | 24.91  | 23.36 |
| DTBM 3-2N   | 3/16                    | 4.76  | 1/8                          | 3.04      | 1/2                   | 12.70 | 1/2   | 12.70 | 13.71 | 16.00 | 18.79 | 24.38  | 18.79 |
| DTBM 3-4N   | 3/16                    | 4.76  | 1/4                          | 3.04      | 1/2                   | 12.70 | 1/2   | 12.70 | 13.71 | 16.00 | 18.79 | 25.40  | 23.36 |
| DTBM 4-1N   | 1/4                     | 6.35  | 1/16                         | 3.04      | 1/2                   | 12.70 | 9/16  | 14.28 | 15.24 | 17.78 | 19.55 | 26.90  | 18.79 |
| DTBM 4-2N   | 1/4                     | 6.35  | 1/8                          | 4.82      | 1/2                   | 12.70 | 9/16  | 14.28 | 15.24 | 17.78 | 19.55 | 26.92  | 19.10 |
| DTBM 4-4N   | 1/4                     | 6.35  | 1/4                          | 4.82      | 1/2                   | 12.70 | 9/16  | 14.28 | 15.24 | 17.78 | 19.55 | 27.08  | 23.87 |
| DTBM 4-6N   | 1/4                     | 6.35  | 3/8                          | 4.82      | 11/16                 | 17.46 | 9/16  | 14.28 | 15.24 | 17.78 | 22.35 | 29.71  | 28.40 |
| DTBM 4-8N   | 1/4                     | 6.35  | 1/2                          | 4.82      | 13/16                 | 20.64 | 9/16  | 14.28 | 15.24 | 17.78 | 24.60 | 31.97  | 35.10 |
| DTBM 5-2N   | 5/16                    | 7.93  | 1/8                          | 4.82      | 9/16                  | 14.28 | 5/8   | 15.87 | 16.25 | 18.54 | 22.35 | 29.71  | 19.81 |
| DTBM 5-4N   | 5/16                    | 7.93  | 1/4                          | 6.35      | 9/16                  | 14.28 | 5/8   | 15.87 | 16.25 | 18.54 | 22.35 | 29.77  | 24.50 |
| DTBM 5-6N   | 5/16                    | 7.93  | 3/8                          | 6.35      | 11/16                 | 17.46 | 5/8   | 15.87 | 16.25 | 18.54 | 23.11 | 30.48  | 28.40 |
| DTBM 6-4N   | 3/8                     | 9.52  | 1/4                          | 7.11      | 5/8                   | 15.87 | 11/16 | 17.46 | 16.76 | 19.30 | 23.11 | 30.48  | 25.40 |
| DTBM 6-6N   | 3/8                     | 9.52  | 3/8                          | 7.11      | 11/16                 | 17.46 | 11/16 | 17.46 | 16.76 | 19.30 | 23.87 | 31.24  | 28.44 |
| DTBM 6-8N   | 3/8                     | 9.52  | 1/2                          | 7.11      | 13/16                 | 20.64 | 11/16 | 17.46 | 16.76 | 19.30 | 25.90 | 33.27  | 33.02 |
| DTBM 6-12N  | 3/8                     | 9.52  | 3/4                          | 7.11      | 1-1/16                | 26.98 | 11/16 | 17.46 | 16.76 | 19.30 | 29.71 | 37.08  | 36.83 |
| DTBM 8-4N   | 1/2                     | 12.70 | 1/4                          | 7.11      | 13/16                 | 20.64 | 7/8   | 22.22 | 22.86 | 21.84 | 25.90 | 36.06  | 28.30 |
| DTBM 8-6N   | 1/2                     | 12.70 | 3/8                          | 10.41     | 13/16                 | 20.64 | 7/8   | 22.22 | 22.86 | 21.84 | 25.90 | 36.06  | 28.30 |
| DTBM 8-8N   | 1/2                     | 12.70 | 1/2                          | 10.41     | 13/16                 | 20.64 | 7/8   | 22.22 | 22.86 | 21.84 | 25.90 | 36.06  | 33.02 |
| DTBM 8-12N  | 1/2                     | 12.70 | 3/4                          | 10.41     | 1-1/16                | 26.98 | 7/8   | 22.22 | 22.86 | 21.84 | 29.71 | 39.87  | 36.83 |
| DTBM 10-6N  | 5/8                     | 15.87 | 3/8                          | 9.65      | 15/16                 | 23.81 | 1     | 25.40 | 24.38 | 21.84 | 27.90 | 38.10  | 29.40 |
| DTBM 10-8N  | 5/8                     | 15.87 | 1/2                          | 11.93     | 15/16                 | 23.81 | 1     | 25.40 | 24.38 | 21.84 | 27.90 | 38.10  | 34.00 |
| DTBM 10-12N | 5/8                     | 15.87 | 3/4                          | 12.70     | 1-1/16                | 26.98 | 1     | 25.40 | 24.38 | 21.84 | 29.71 | 39.87  | 36.83 |
| DTBM 12-8N  | 3/4                     | 19.05 | 1/2                          | 11.93     | 1-1/16                | 26.98 | 1-1/8 | 28.58 | 24.38 | 21.84 | 29.71 | 39.87  | 37.00 |
| DTBM 12-12N | 3/4                     | 19.05 | 3/4                          | 15.74     | 1-1/16                | 26.98 | 1-1/8 | 28.58 | 24.38 | 21.84 | 29.71 | 39.87  | 36.83 |
| DTBM 14-12N | 7/8                     | 22.22 | 3/4                          | 15.74     | 1-3/8                 | 34.92 | 1-1/4 | 31.75 | 25.90 | 21.84 | 34.54 | 44.70  | 41.65 |
| DTBM 16-12N | 1                       | 25.40 | 3/4                          | 15.74     | 1-3/8                 | 34.92 | 1-1/2 | 38.10 | 31.24 | 26.41 | 36.83 | 49.02  | 42.20 |
| DTBM 16-16N | 1                       | 25.40 | 1                            | 22.35     | 1-3/8                 | 34.92 | 1-1/2 | 38.10 | 31.24 | 26.41 | 36.83 | 49.02  | 46.70 |
| DTBM 20-20N | 1-1/4                   | 31.75 | 1-1/4                        | 27.68     | 1-11/16               | 42.86 | 1-7/8 | 47.63 | 41.14 | 38.86 | 44.50 | 66.54  | 47.75 |
| DTBM 24-24N | 1-1/2                   | 38.10 | 1-1/2                        | 33.90     | 2                     | 50.80 | 2-1/4 | 57.15 | 50.03 | 45.21 | 50.80 | 77.97  | 60.45 |
| DTBM 32-32N | 2                       | 50.80 | 2                            | 45.97     | 2-3/4                 | 69.85 | 3     | 76.20 | 67.56 | 62.73 | 69.80 | 107.18 | 70.61 |

Присоединение трубки дюймовых размеров к внутренней конической резьбе ISO

| Код        | Наружный диаметр трубки |       |                       |           | Размер гайки под ключ |       |      |       | A     | B     | ℓ     | L     | L1    |
|------------|-------------------------|-------|-----------------------|-----------|-----------------------|-------|------|-------|-------|-------|-------|-------|-------|
|            | D                       |       | T<br>Размер<br>резьбы | E<br>Мин. | h                     |       | H    |       |       |       |       |       |       |
|            | дюйм                    | мм    |                       |           | дюйм                  | мм    | дюйм | мм    |       |       |       |       |       |
| DTBM 6-4R  | 3/8                     | 9.52  | 1/4                   | 7.11      | 5/8                   | 15.87 | 1/16 | 17.46 | 16.76 | 19.30 | 23.11 | 30.48 | 25.40 |
| DTBM 8-6R  | 1/2                     | 12.70 | 3/8                   | 9.65      | 13/16                 | 20.64 | 7/8  | 22.22 | 22.86 | 21.84 | 25.90 | 36.06 | 28.30 |
| DTBM 8-8R  | 1/2                     | 12.70 | 1/2                   | 10.41     | 13/16                 | 20.64 | 7/8  | 22.22 | 22.86 | 21.84 | 25.90 | 36.06 | 33.02 |
| DTBM 10-8R | 5/8                     | 15.87 | 1/2                   | 11.93     | 15/16                 | 23.81 | 1    | 25.40 | 24.38 | 21.84 | 27.90 | 38.10 | 34.00 |

## ФИТИНГИ

Симметричный ввертной тройник

## DTBM-N

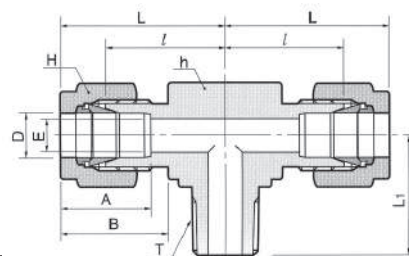

Присоединение метрических трубок к внутренней резьбе NPT

| Код          | Наружный диаметр трубки |                           |           | Размер гайки под ключ |    |      |      |      |      |      |
|--------------|-------------------------|---------------------------|-----------|-----------------------|----|------|------|------|------|------|
|              | D                       | Т<br>Размер резьбы<br>NPT | Е<br>Мин. | h                     | H  | A    | B    | ℓ    | L    | L1   |
| DTBM 3M-2N   | 3                       | 1/8                       | 2.4       | 12.7                  | 12 | 12.9 | 15.3 | 17.0 | 23.6 | 17.8 |
| DTBM 3M-4N   | 3                       | 1/4                       | 2.4       | 12.7                  | 12 | 12.9 | 15.3 | 18.0 | 24.6 | 23.4 |
| DTBM 4M-2N   | 4                       | 1/8                       | 2.4       | 12.7                  | 12 | 13.7 | 16.1 | 18.8 | 25.4 | 18.8 |
| DTBM 4M-4N   | 4                       | 1/4                       | 2.4       | 12.7                  | 12 | 13.7 | 16.1 | 18.8 | 25.4 | 23.4 |
| DTBM 6M-2N   | 6                       | 1/8                       | 4.8       | 12.7                  | 14 | 15.3 | 17.7 | 19.6 | 27.0 | 18.8 |
| DTBM 6M-4N   | 6                       | 1/4                       | 4.8       | 14.2                  | 14 | 15.3 | 17.7 | 19.6 | 27.0 | 23.4 |
| DTBM 6M-6N   | 6                       | 3/8                       | 4.8       | 17.5                  | 14 | 15.3 | 17.7 | 22.4 | 29.8 | 26.2 |
| DTBM 6M-8N   | 6                       | 1/2                       | 4.8       | 20.6                  | 14 | 15.3 | 17.7 | 24.4 | 31.8 | 33.0 |
| DTBM 8M-2N   | 8                       | 1/8                       | 4.8       | 14.3                  | 16 | 16.2 | 18.6 | 21.3 | 28.8 | 19.8 |
| DTBM 8M-4N   | 8                       | 1/4                       | 6.4       | 14.3                  | 16 | 16.2 | 18.6 | 21.3 | 28.8 | 24.4 |
| DTBM 8M-6N   | 8                       | 3/8                       | 6.4       | 17.5                  | 16 | 16.2 | 18.6 | 23.1 | 30.6 | 26.2 |
| DTBM 8M-8N   | 8                       | 1/2                       | 6.4       | 20.6                  | 16 | 16.2 | 18.6 | 25.1 | 32.6 | 33.0 |
| DTBM 10M-2N  | 10                      | 1/8                       | 4.8       | 17.5                  | 19 | 17.2 | 19.5 | 23.9 | 31.5 | 23.6 |
| DTBM 10M-4N  | 10                      | 1/4                       | 7.1       | 17.5                  | 19 | 17.2 | 19.5 | 23.9 | 31.5 | 26.2 |
| DTBM 10M-6N  | 10                      | 3/8                       | 7.9       | 17.5                  | 19 | 17.2 | 19.5 | 23.9 | 31.5 | 26.2 |
| DTBM 10M-8N  | 10                      | 1/2                       | 7.9       | 20.6                  | 19 | 17.2 | 19.5 | 25.9 | 33.5 | 33.0 |
| DTBM 12M-2N  | 12                      | 1/8                       | 4.8       | 20.6                  | 22 | 22.8 | 22.0 | 25.9 | 36.0 | 23.6 |
| DTBM 12M-4N  | 12                      | 1/4                       | 7.1       | 20.6                  | 22 | 22.8 | 22.0 | 25.9 | 36.0 | 28.2 |
| DTBM 12M-6N  | 12                      | 3/8                       | 9.5       | 20.6                  | 22 | 22.8 | 22.0 | 25.9 | 36.0 | 28.2 |
| DTBM 12M-8N  | 12                      | 1/2                       | 9.5       | 20.6                  | 22 | 22.8 | 22.0 | 25.9 | 36.0 | 33.0 |
| DTBM 12M-12N | 12                      | 3/4                       | 9.5       | 27.0                  | 22 | 22.8 | 22.0 | 29.7 | 39.8 | 36.8 |
| DTBM 16M-6N  | 16                      | 3/8                       | 9.5       | 25.4                  | 25 | 24.4 | 22.0 | 27.9 | 38.0 | 30.2 |
| DTBM 16M-8N  | 16                      | 1/2                       | 11.9      | 25.4                  | 25 | 24.4 | 22.0 | 27.9 | 38.0 | 35.1 |
| DTBM 16M-12N | 16                      | 3/4                       | 12.7      | 27.0                  | 25 | 24.4 | 22.0 | 29.7 | 39.8 | 36.8 |
| DTBM 18M-8N  | 18                      | 1/2                       | 11.9      | 27.0                  | 30 | 24.4 | 22.0 | 29.7 | 39.8 | 36.8 |
| DTBM 18M-12N | 18                      | 3/4                       | 15.1      | 27.0                  | 30 | 24.4 | 22.0 | 29.7 | 39.8 | 36.8 |
| DTBM 20M-8N  | 20                      | 1/2                       | 11.9      | 34.92                 | 32 | 26.0 | 22.0 | 34.5 | 44.6 | 41.7 |
| DTBM 20M-12N | 20                      | 3/4                       | 15.9      | 34.92                 | 32 | 26.0 | 22.0 | 34.5 | 44.6 | 41.7 |
| DTBM 22M-12N | 22                      | 3/4                       | 15.9      | 34.92                 | 32 | 26.0 | 22.0 | 34.5 | 44.6 | 41.7 |
| DTBM 22M-16N | 22                      | 1                         | 18.3      | 34.92                 | 32 | 26.0 | 22.0 | 34.5 | 44.6 | 46.5 |
| DTBM 25M-12N | 25                      | 3/4                       | 15.9      | 34.92                 | 38 | 31.3 | 26.5 | 36.8 | 49.1 | 41.7 |
| DTBM 25M-16N | 25                      | 1                         | 21.8      | 34.92                 | 38 | 31.3 | 26.5 | 36.8 | 49.1 | 46.5 |

## ОБЖИМНЫЕ ФИТИНГИ

Симметричный ввертной тройник

### DTBM-R

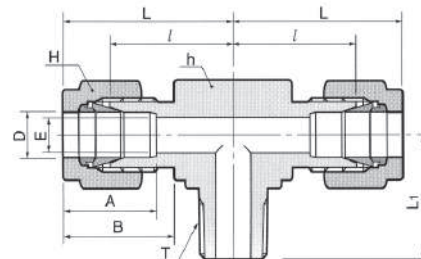

Присоединение метрических трубок к внутренней конической резьбе ISO

| Код          | Наружный диаметр трубки |                       | E<br>Мин. | Размер гайки под ключ |    | A    | B    | ℓ    | L    | L1   |
|--------------|-------------------------|-----------------------|-----------|-----------------------|----|------|------|------|------|------|
|              | D                       | T<br>Размер<br>резьбы |           | h                     | H  |      |      |      |      |      |
| DTBM 3M-2R   | 3                       | 1/8                   | 2.4       | 12.7                  | 12 | 12.9 | 15.3 | 17.0 | 23.6 | 17.8 |
| DTBM 3M-4R   | 3                       | 1/4                   | 2.4       | 12.7                  | 12 | 12.9 | 15.3 | 18.0 | 24.6 | 23.4 |
| DTBM 4M-2R   | 4                       | 1/8                   | 2.4       | 12.7                  | 12 | 13.7 | 16.1 | 18.8 | 25.4 | 18.8 |
| DTBM 4M-4R   | 4                       | 1/4                   | 2.4       | 12.7                  | 12 | 13.7 | 16.1 | 18.8 | 25.4 | 23.4 |
| DTBM 6M-2R   | 6                       | 1/8                   | 4.8       | 12.7                  | 14 | 15.3 | 17.7 | 19.6 | 27.0 | 18.8 |
| DTBM 6M-4R   | 6                       | 1/4                   | 4.8       | 14.2                  | 14 | 15.3 | 17.7 | 19.6 | 27.0 | 23.4 |
| DTBM 6M-6R   | 6                       | 3/8                   | 4.8       | 17.5                  | 14 | 15.3 | 17.7 | 22.4 | 29.8 | 26.2 |
| DTBM 6M-8R   | 6                       | 1/2                   | 4.8       | 20.6                  | 14 | 15.3 | 17.7 | 24.4 | 31.8 | 33.0 |
| DTBM 8M-2R   | 8                       | 1/8                   | 4.8       | 14.3                  | 16 | 16.2 | 18.6 | 21.3 | 28.8 | 19.8 |
| DTBM 8M-4R   | 8                       | 1/4                   | 6.4       | 14.3                  | 16 | 16.2 | 18.6 | 21.3 | 28.8 | 24.4 |
| DTBM 8M-6R   | 8                       | 3/8                   | 6.4       | 17.5                  | 16 | 16.2 | 18.6 | 23.1 | 30.6 | 26.2 |
| DTBM 8M-8R   | 8                       | 1/2                   | 6.4       | 20.6                  | 16 | 16.2 | 18.6 | 25.1 | 32.6 | 33.0 |
| DTBM 10M-2R  | 10                      | 1/8                   | 4.8       | 17.5                  | 19 | 17.2 | 19.5 | 23.9 | 31.5 | 23.6 |
| DTBM 10M-4R  | 10                      | 1/4                   | 7.1       | 17.5                  | 19 | 17.2 | 19.5 | 23.9 | 31.5 | 26.2 |
| DTBM 10M-6R  | 10                      | 3/8                   | 7.9       | 17.5                  | 19 | 17.2 | 19.5 | 23.9 | 31.5 | 26.2 |
| DTBM 10M-8R  | 10                      | 1/2                   | 7.9       | 20.6                  | 19 | 17.2 | 19.5 | 25.9 | 33.5 | 33.0 |
| DTBM 12M-2R  | 12                      | 1/8                   | 4.8       | 20.6                  | 22 | 22.8 | 22.0 | 25.9 | 36.0 | 23.6 |
| DTBM 12M-4R  | 12                      | 1/4                   | 7.1       | 20.6                  | 22 | 22.8 | 22.0 | 25.9 | 36.0 | 28.2 |
| DTBM 12M-6R  | 12                      | 3/8                   | 9.5       | 20.6                  | 22 | 22.8 | 22.0 | 25.9 | 36.0 | 28.2 |
| DTBM 12M-8R  | 12                      | 1/2                   | 9.5       | 20.6                  | 22 | 22.8 | 22.0 | 25.9 | 36.0 | 33.0 |
| DTBM 12M-12R | 12                      | 3/4                   | 9.5       | 27.0                  | 22 | 22.8 | 22.0 | 29.7 | 39.8 | 36.8 |
| DTBM 16M-6R  | 16                      | 3/8                   | 9.5       | 25.4                  | 25 | 24.4 | 22.0 | 27.9 | 38.0 | 30.2 |
| DTBM 16M-8R  | 16                      | 1/2                   | 11.9      | 25.4                  | 25 | 24.4 | 22.0 | 27.9 | 38.0 | 35.1 |
| DTBM 16M-12R | 16                      | 3/4                   | 12.7      | 27.0                  | 25 | 24.4 | 22.0 | 29.7 | 39.8 | 36.8 |
| DTBM 18M-8R  | 18                      | 1/2                   | 11.9      | 27.0                  | 30 | 24.4 | 22.0 | 29.7 | 39.8 | 36.8 |
| DTBM 18M-12R | 18                      | 3/4                   | 15.1      | 27.0                  | 30 | 24.4 | 22.0 | 29.7 | 39.8 | 36.8 |
| DTBM 20M-8R  | 20                      | 1/2                   | 11.9      | 34.92                 | 32 | 26.0 | 22.0 | 34.5 | 44.6 | 41.7 |
| DTBM 20M-12R | 20                      | 3/4                   | 15.9      | 34.92                 | 32 | 26.0 | 22.0 | 34.5 | 44.6 | 41.7 |
| DTBM 22M-12R | 22                      | 3/4                   | 15.9      | 34.92                 | 32 | 26.0 | 22.0 | 34.5 | 44.6 | 41.7 |
| DTBM 22M-16R | 22                      | 1                     | 18.3      | 34.92                 | 32 | 26.0 | 22.0 | 34.5 | 44.6 | 46.5 |
| DTBM 25M-12R | 25                      | 3/4                   | 15.9      | 34.92                 | 38 | 31.3 | 26.5 | 36.8 | 49.1 | 41.7 |
| DTBM 25M-16R | 25                      | 1                     | 21.8      | 34.92                 | 38 | 31.3 | 26.5 | 36.8 | 49.1 | 46.5 |